



FOR LEASE

24 N ADAMS AVE (BUILDING 256)

137,030 SF
ENDICOTT, NY

ROBERT KRIEWALDT 920-915-9746 | ROBERT@PHOENIX3PL.COM



PHOENIX
LOGISTICS

Strategic Real Estate. Applied Technology. Tailored Service.

This document has been prepared by Phoenix Investors for advertising and general information only. Phoenix Investors makes no guarantees, representations, or warranties of any kind, expressed or implied, regarding the information including, but not limited to, warranties of content, accuracy, and reliability.

PROPERTY DETAILS

24 N ADAMS AVE (BUILDING 256) | ENDICOTT, NY

AVAILABLE SPACE	137,030 SF
-----------------	------------

MINIMUM DIVISIBLE	10,000 SF
-------------------	-----------

FLOORS	3
--------	---

ELEVATORS	2
-----------	---

YEAR BUILT	1984
------------	------

ZONING	Industrial
--------	------------

PARCEL ID	141.19-4-16
-----------	-------------

FLOOR PLAN

24 N ADAMS AVE (BUILDING 256) | ENDICOTT, NY

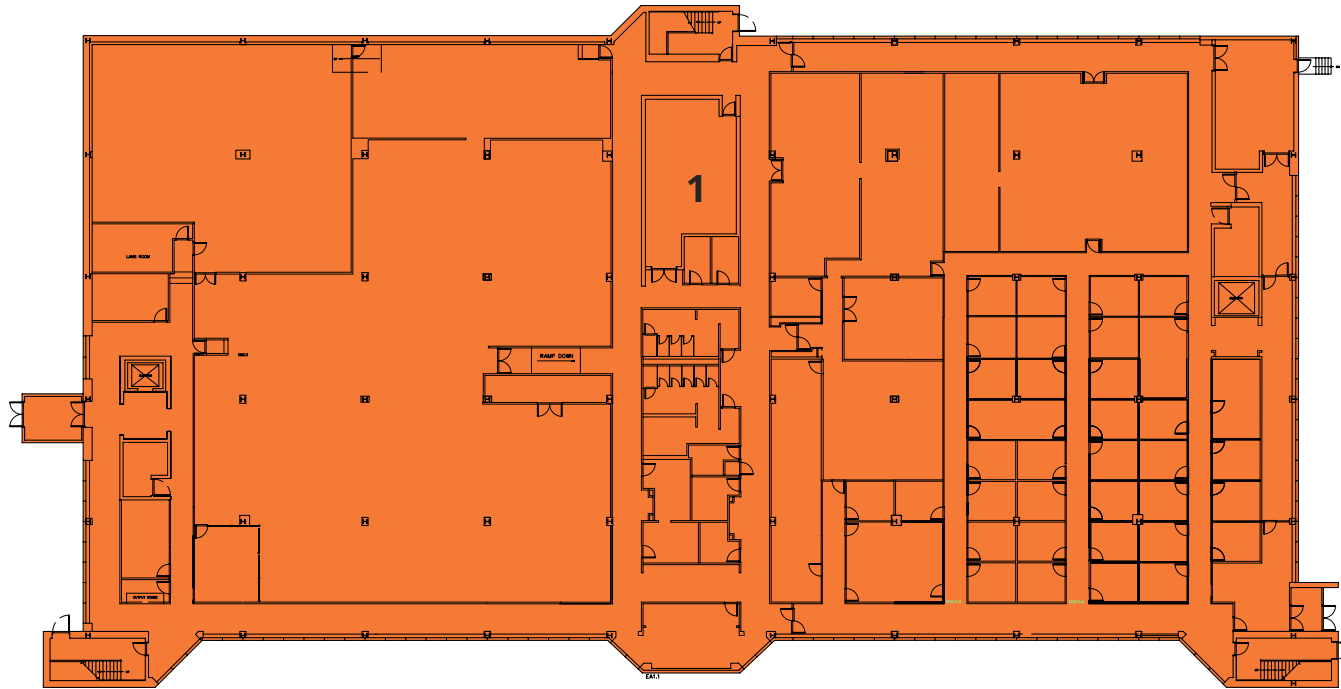

NUMBER	SPACE DESIGNATION	SQUARE FEET
1	AVAILABLE	45,828 SF
TOTAL		45,828 SF

FIRST FLOOR



FLOOR PLAN

24 N ADAMS AVE (BUILDING 256) | ENDICOTT, NY

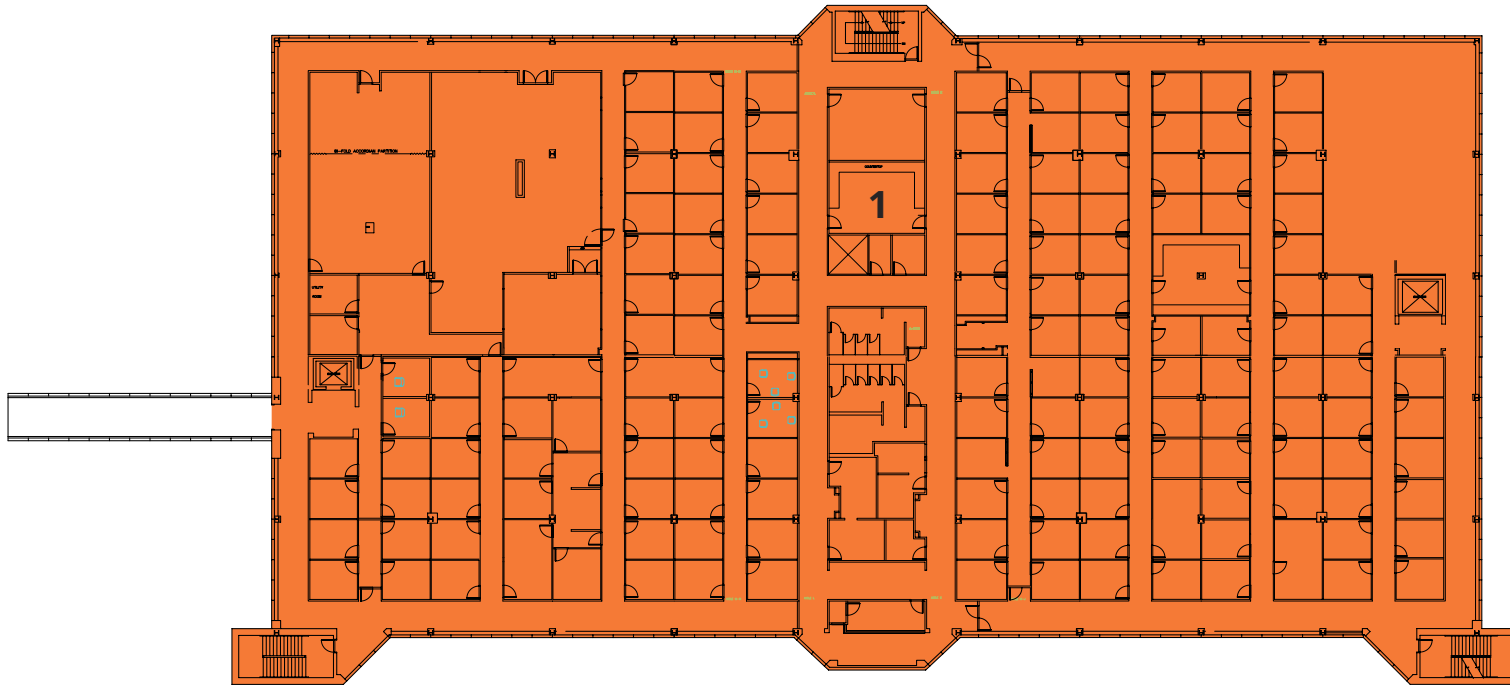

NUMBER	SPACE DESIGNATION	SQUARE FEET
1	AVAILABLE	45,601 SF
TOTAL		45,601 SF

SECOND FLOOR



FLOOR PLAN

24 N ADAMS AVE (BUILDING 256) | ENDICOTT, NY

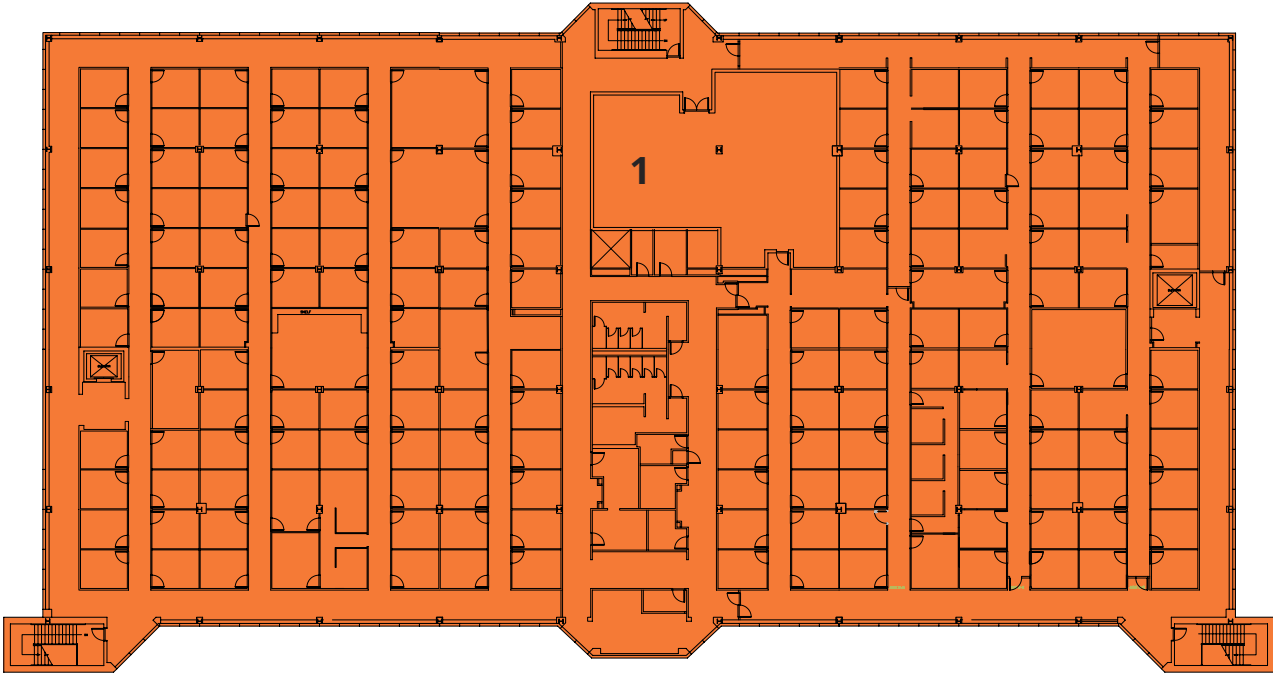

NUMBER	SPACE DESIGNATION	SQUARE FEET
1	AVAILABLE	45,601 SF
TOTAL		45,601 SF

THIRD FLOOR

