



**FOR LEASE**  
1709 - 1769 LATHAM ST

**213,519 SF**  
**MEMPHIS, TN**



**PHOENIX**  
**LOGISTICS**

*Strategic Real Estate. Applied Technology. Tailored Service.*

**ROBERT KRIEWALDT 920-915-9746 | ROBERT@PHOENIX3PL.COM**

This document has been prepared by Phoenix Investors for advertising and general information only. Phoenix Investors makes no guarantees, representations, or warranties of any kind, expressed or implied, regarding the information including, but not limited to, warranties of content, accuracy, and reliability.



# PROPERTY HIGHLIGHTS



**NEW EXTERIOR  
PAINT (2025)**



**WHITEBOX  
RENOVATIONS (2025)**



**VARIOUS SUITE SIZES  
AVAILABLE**



**NEW ROOF (2025)**



# PROPERTY DETAILS

1709 - 1769 LATHAM ST | MEMPHIS, TN

|                            |                     |
|----------------------------|---------------------|
| AVAILABLE SPACE            | 213,519 SF          |
| MINIMUM DIVISIBLE          | 19,333 SF           |
| CLEAR HEIGHT               | 12' - 24'           |
| DOCK DOORS                 | 18                  |
| GRADE-LEVEL DRIVE-IN DOORS | 2                   |
| ROOF                       | TPO                 |
| WALLS                      | Masonry             |
| FLOORS                     | Reinforced Concrete |
| YEAR BUILT                 | 1950                |
| LIGHTING                   | Fluorescent         |
| FIRE SUPPRESSION           | Wet                 |
| LAND AREA                  | 8.13 Acres          |
| ZONING                     | EMP: Industrial     |

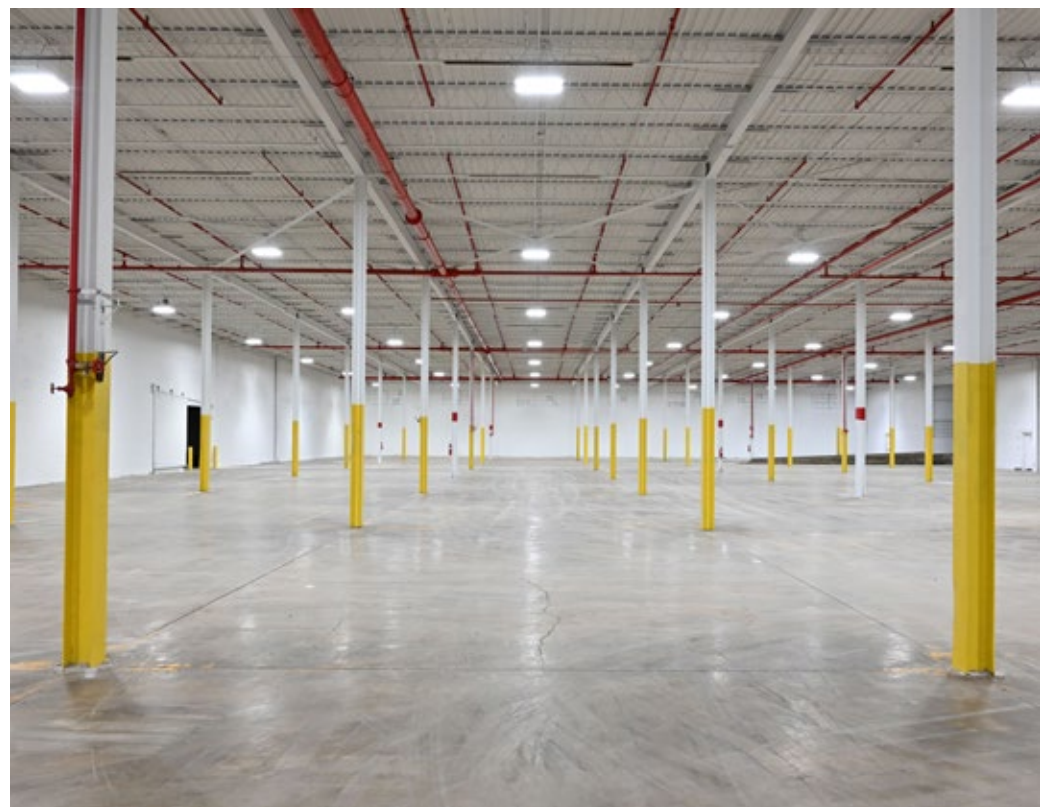

# FLOOR PLAN

1709 - 1769 LATHAM ST | MEMPHIS, TN

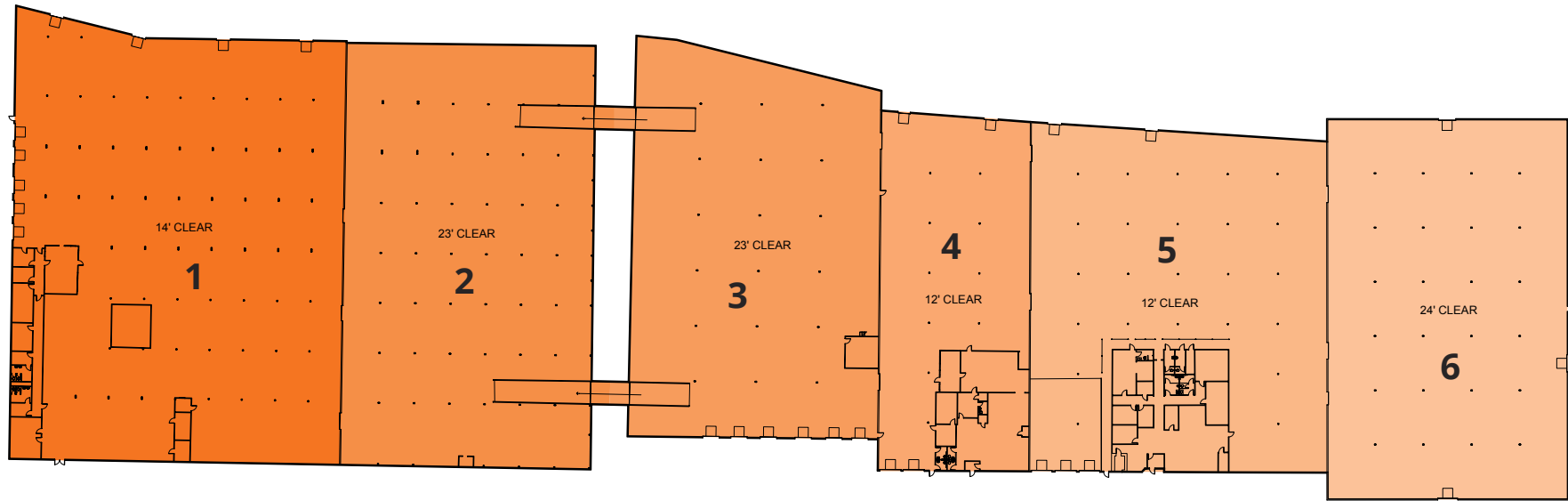

| NUMBER       | SPACE DESIGNATION | CLEAR HEIGHT | DOCK DOORS | SQUARE FEET       |
|--------------|-------------------|--------------|------------|-------------------|
| 1            | AVAILABLE         | 14'          | 5          | 51,487 SF         |
| 2            | AVAILABLE         | 23'          | N/A        | 38,627 SF         |
| 3            | AVAILABLE         | 23'          | 6          | 34,285 SF         |
| 4            | AVAILABLE         | 12'          | 2          | 19,333 SF         |
| 5            | AVAILABLE         | 12'          | 3          | 36,610 SF         |
| 6            | AVAILABLE         | 24'          | 2          | 33,177 SF         |
| <b>TOTAL</b> |                   |              |            | <b>213,519 SF</b> |

[VIEW A MATTERPORT WALK-THROUGH](#)

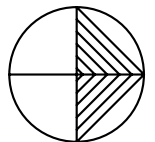

# LOCATION MAP

1709 - 1769 LATHAM ST | MEMPHIS, TN

|                       |           |
|-----------------------|-----------|
| I-240                 | 3 MILES   |
| I-55                  | 3 MILES   |
| MEMPHIS INT'L AIRPORT | 9 MILES   |
| TUPELO, MS            | 113 MILES |
| LITTLE ROCK, AR       | 139 MILES |
| NASHVILLE, TN         | 215 MILES |
| ST. LOUIS, MO         | 286 MILES |
| ATLANTA, GA           | 381 MILES |
| LOUISVILLE, KY        | 387 MILES |

