



FOR LEASE | **267,193 SF**
900 - 1000 TYRONE PIKE | **VERSAILLES, KY**

ROBERT KRIEWALDT 920-915-9746 | ROBERT@PHOENIX3PL.COM



PHOENIX
LOGISTICS
Strategic Real Estate. Applied Technology. Tailored Service.

This document has been prepared by Phoenix Investors for advertising and general information only. Phoenix Investors makes no guarantees, representations, or warranties of any kind, expressed or implied, regarding the information including, but not limited to, warranties of content, accuracy, and reliability.



PROPERTY HIGHLIGHTS



**LOCATED ON
HIGHWAY 60 WITH
EASY ACCESS TO I-64**



**EXTENSIVE RAIL
INFRASTRUCTURE**



**ENTIRE SITE IS
FULLY FENCED &
SECURED**



**NEW DOCKS
RECENTLY
INSTALLED**



PROPERTY DETAILS

900 - 1000 TYRONE PIKE | VERSAILLES, KY

AVAILABLE SPACE	267,193 SF
MINIMUM DIVISIBLE	2,713 SF
MAXIMUM CONTIGUOUS	207,593 SF
FLOORS	1
DOCK DOORS	8
DRIVE-IN DOORS	7
CLEAR HEIGHT	16' - 25'
ROOF	EPDM
WALLS	Metal & Masonry
FLOORS	6" Reinforced Concrete
YEAR BUILT	1964
YEAR RENOVATED	2011
FIRE SUPPRESSION	100% Wet
LIGHTING	LED
POWER	Heavy
PARKING	650 Surface Spaces
LAND AREA	59.82 Acres
ZONING	I-2: Heavy Industrial
PARCEL ID	19-0000-032-00 19-0000-032-DO02 19-0000-021-00
RAIL ACCESS	Yes
OPEX ESTIMATE	\$0.92/SF

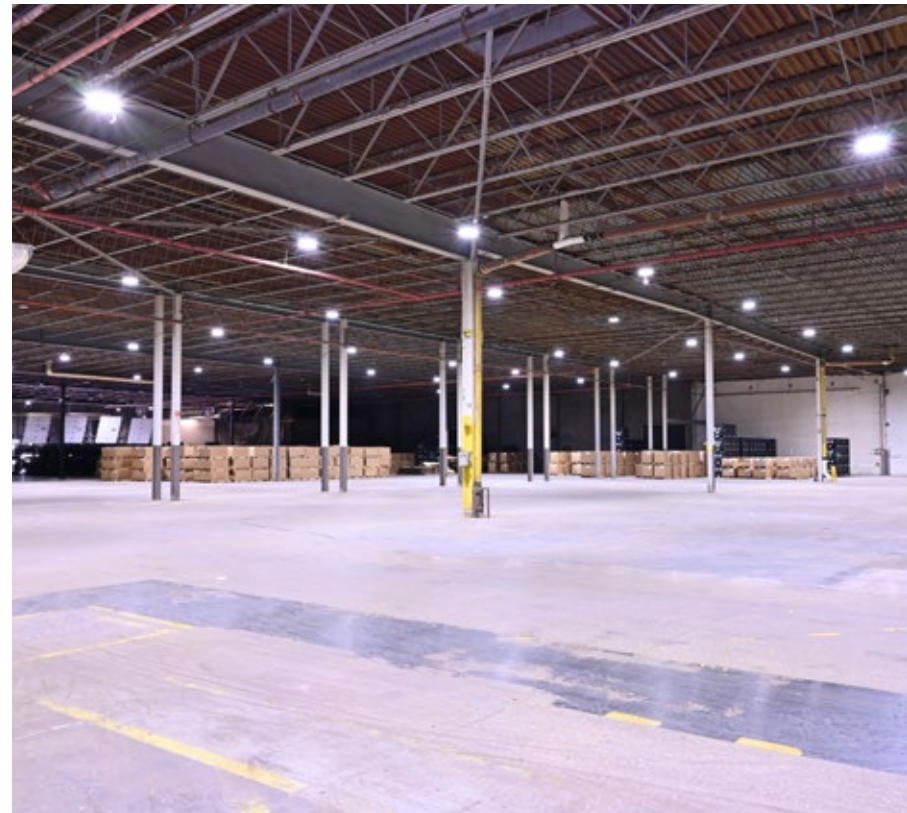

FLOOR PLAN

900 - 1000 TYRONE PIKE | VERSAILLES, KY

[VIEW A VIDEO OF THIS PROPERTY](#)

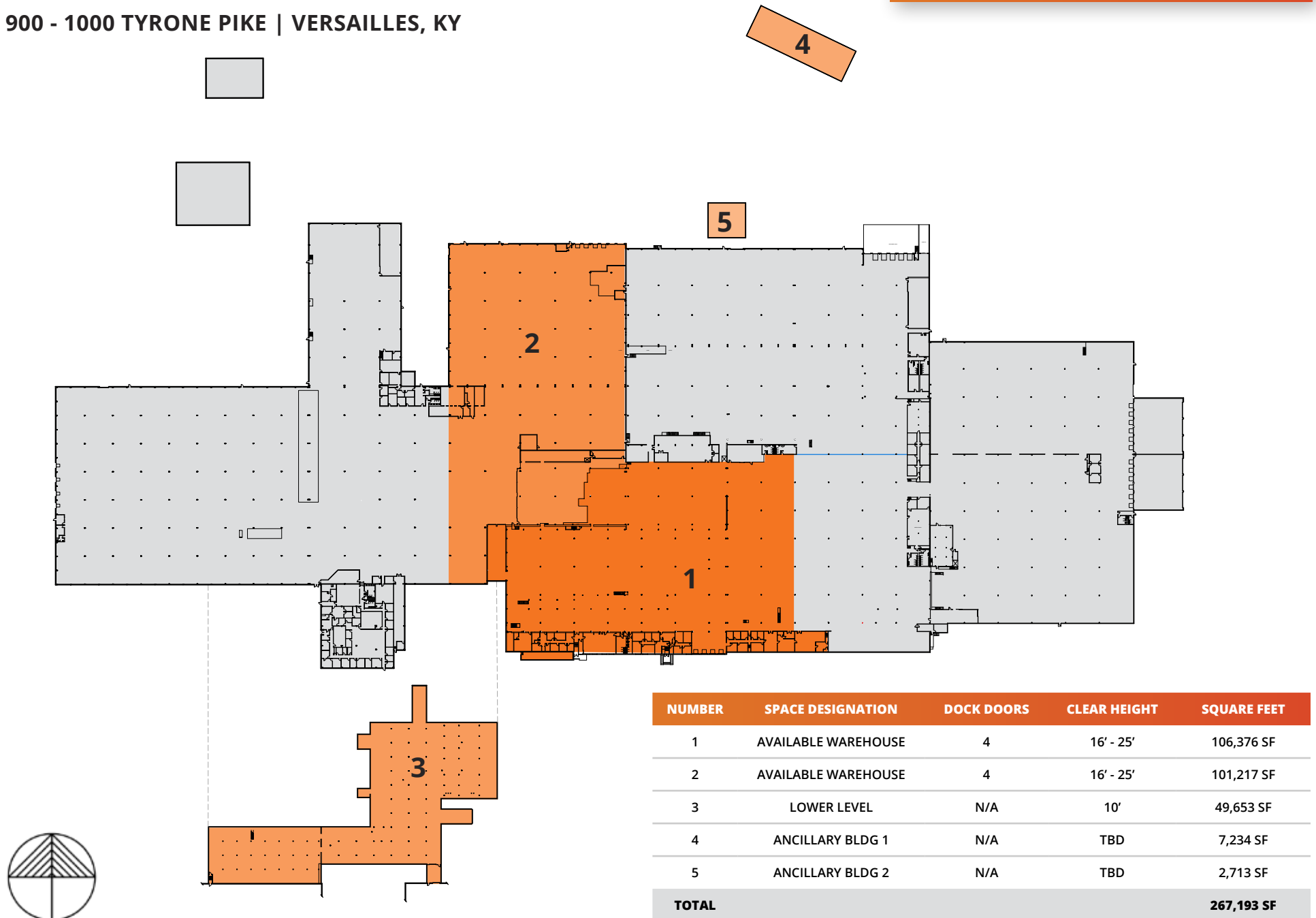

NUMBER	SPACE DESIGNATION	DOCK DOORS	CLEAR HEIGHT	SQUARE FEET
1	AVAILABLE WAREHOUSE	4	16' - 25'	106,376 SF
2	AVAILABLE WAREHOUSE	4	16' - 25'	101,217 SF
3	LOWER LEVEL	N/A	10'	49,653 SF
4	ANCILLARY BLDG 1	N/A	TBD	7,234 SF
5	ANCILLARY BLDG 2	N/A	TBD	2,713 SF
TOTAL				267,193 SF

LOCATION MAP

900 - 1000 TYRONE PIKE | VERSAILLES, KY

LEXINGTON	27 MILES
LOUISVILLE	94 MILES
CINCINNATI	99 MILES
COLUMBUS	206 MILES
INDIANAPOLIS	209 MILES

