



**FOR LEASE** | **269,969 SF**  
**927 N 19TH AVE E** | **NEWTON, IA**

**ROBERT KRIEVALDT** 920-915-9746 | [ROBERT@PHOENIX3PL.COM](mailto:ROBERT@PHOENIX3PL.COM)



**PHOENIX**  
**LOGISTICS**

*Strategic Real Estate. Applied Technology. Tailored Service.*

This document has been prepared by Phoenix Investors for advertising and general information only. Phoenix Investors makes no guarantees, representations, or warranties of any kind, expressed or implied, regarding the information including, but not limited to, warranties of content, accuracy, and reliability.



# PROPERTY HIGHLIGHTS



**CONVENIENT  
ACCESS TO I-80**



**30 MINUTES TO I-35  
AND DES MOINES**



**RENOVATED  
IN 2020**



# PROPERTY DETAILS

927 N 19TH AVE E | NEWTON, IA

|                      |   |
|----------------------|---|
| AVAILABLE SPACE      | 269,969 SF  |
| ELEVATORS            | Yes   |
| ROOF                 | Reinforced Rubber Membrane  |
| WALLS                | Metal & Masonry   |
| FLOORS               | 6" - 12" Reinforced Concrete  |
| YEAR BUILT           | 1948 - 1957   |
| YEAR RENOVATED       | 2020  |
| FIRE SUPPRESSION     | 100% Wet  |
| LIGHTING             | LED   |
| POWER                | One Substation, 13.2 KV @ 480V, 3-Phase   |
| PARKING              | 1,837 Surface Spaces  |
| LAND AREA            | 105.65 Acres  |
| ZONING               | I-H: Heavy Industrial   |
| PARCEL ID            | 823300008   826101001   826103004<br>826103007   827226002   827226003<br>827276002   827276003   827276007 |
| RAIL                 | Yes: IIR  |
| <b>OPEX ESTIMATE</b> | <b>\$0.85/SF</b>  |

|                                       |                               |
|---------------------------------------|-------------------------------|
|                                       | 56,600 SF                     |
|                                       | Clear Height: 20' - 27'       |
| <b>AVAILABLE WH 1 (BLDG 125, 161)</b> | OH Drive-in Doors: 2          |
|                                       | 40-Ton Crane                  |
|                                       | Restrooms                     |
|                                       | 104,414 SF                    |
|                                       | Clear Height: 17' 8" - 36' 6" |
|                                       | OH Drive-in Doors: 2          |
| <b>AVAILABLE WH 2 (BLDG 143)</b>      | Docks: 4                      |
|                                       | Restrooms                     |
|                                       | Small Office                  |
|                                       | ESFR Fire Protection          |
|                                       | 47,509 SF                     |
|                                       | 4 Floors                      |
| <b>AVAILABLE OFFICE (BLDG 162)</b>    | Restrooms                     |
|                                       | Private Offices               |
|                                       | Conference Rooms              |
|                                       | 61,444 SF                     |
| <b>AVAILABLE WH 3 (BLDG 142)</b>      | Clear Height: 22'             |
|                                       | Docks: 2                      |
|                                       | Restrooms                     |



# FLOOR PLAN

927 N 19TH AVE E | NEWTON, IA

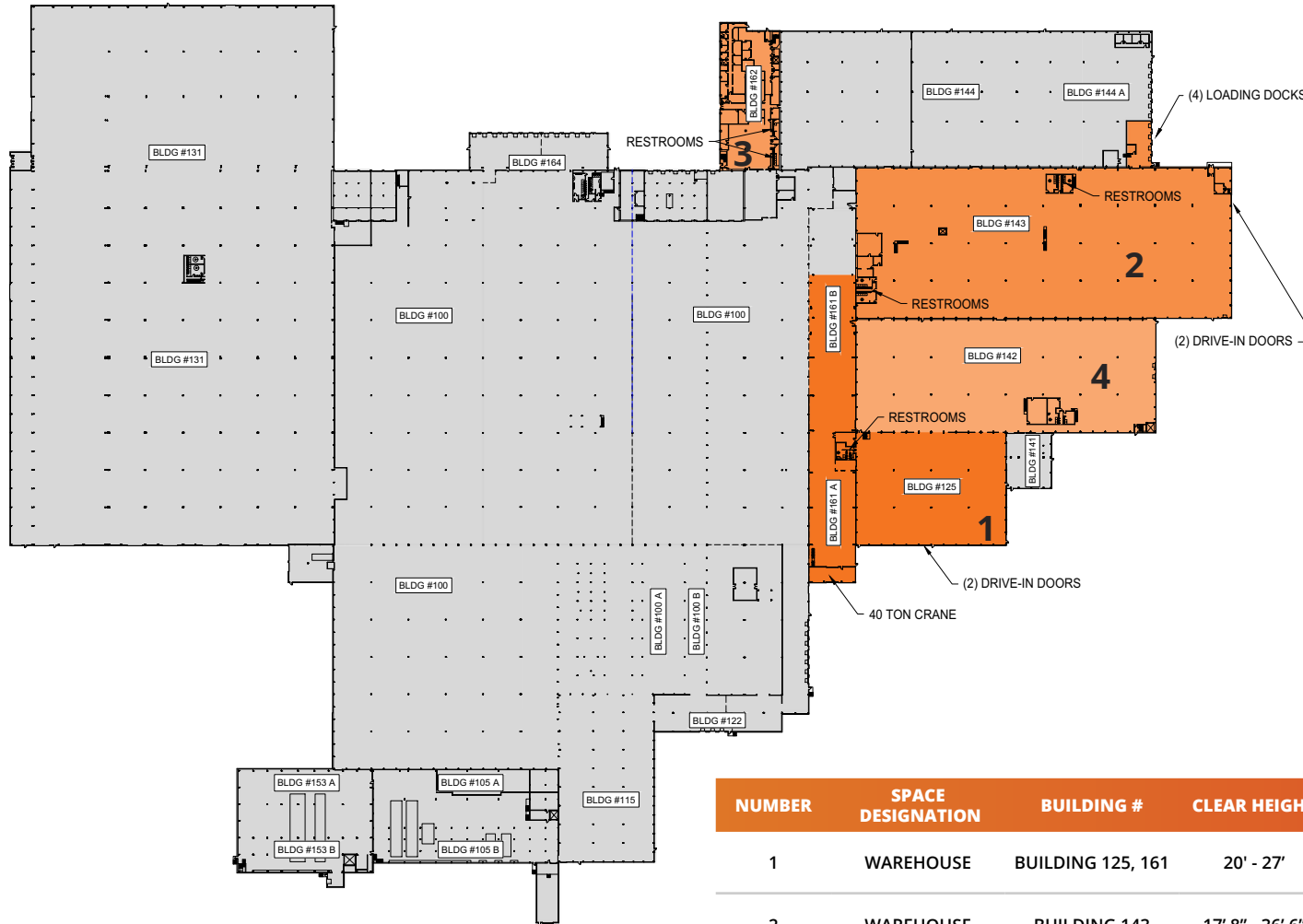
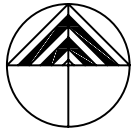

| NUMBER       | SPACE DESIGNATION | BUILDING #                 | CLEAR HEIGHT    | DRIVE-IN OH DOORS | DOCKS | SQUARE FEET       |
|--------------|-------------------|----------------------------|-----------------|-------------------|-------|-------------------|
| 1            | WAREHOUSE         | BUILDING 125, 161          | 20' - 27'       | 2                 | 0     | 56,600 SF         |
| 2            | WAREHOUSE         | BUILDING 143               | 17' 8" - 36' 6" | 2                 | 4     | 104,416 SF        |
| 3            | OFFICE            | BUILDING 162<br>(4 FLOORS) | DROP CEILING    | N/A               | N/A   | 47,509 SF         |
| 4            | WAREHOUSE         | BUILDING 142               | N/A             | N/A               | 2     | 61,444 SF         |
| <b>TOTAL</b> |                   |                            |                 |                   |       | <b>269,969 SF</b> |

