



**FOR LEASE OR SALE** | **378,492 SF**  
**342 SHELBYVILLE MILLS RD** | **SHELBYVILLE, TN**

**ROBERT KRIEVALDT** 920-915-9746 | [ROBERT@PHOENIX3PL.COM](mailto:ROBERT@PHOENIX3PL.COM)



**PHOENIX**  
**LOGISTICS**

*Strategic Real Estate. Applied Technology. Tailored Service.*

This document has been prepared by Phoenix Investors for advertising and general information only. Phoenix Investors makes no guarantees, representations, or warranties of any kind, expressed or implied, regarding the information including, but not limited to, warranties of content, accuracy, and reliability.



## PROPERTY HIGHLIGHTS



**PLANNED  
RENOVATIONS  
2026: WHITEBOX  
RENOVATIONS, LED  
LIGHTS, NEW ROOF,  
& CONCRETE FLOORS**



**RECENTLY  
RENOVATED  
OFFICES**



**AMPLE PARKING**



**FULLY FENCED  
& SECURED WITH  
GUARDSHACK**



# PROPERTY DETAILS

342 SHELBYVILLE MILLS RD | SHELBYVILLE, TN

AVAILABLE SPACE	378,492 SF
DOCK DOORS	7
GRADE-LEVEL DRIVE-IN DOORS	2
CLEAR HEIGHT	10' - 25'
ROOF	TPO Overlay
WALLS	Masonry & Metal
FLOORS	Reinforced Concrete
YEAR BUILT	1929
YEAR RENOVATED	2026
LIGHTING	LED
POWER	6, 480V Utility Feeds 2 Modernized 1600A GE Switchboards
PARKING	Ample
LAND AREA	107.67 Acres
ZONING	I2: Industrial Heavy
PARCEL ID	002088 04800



# FLOOR PLAN

342 SHELBYVILLE MILLS RD | SHELBYVILLE, TN

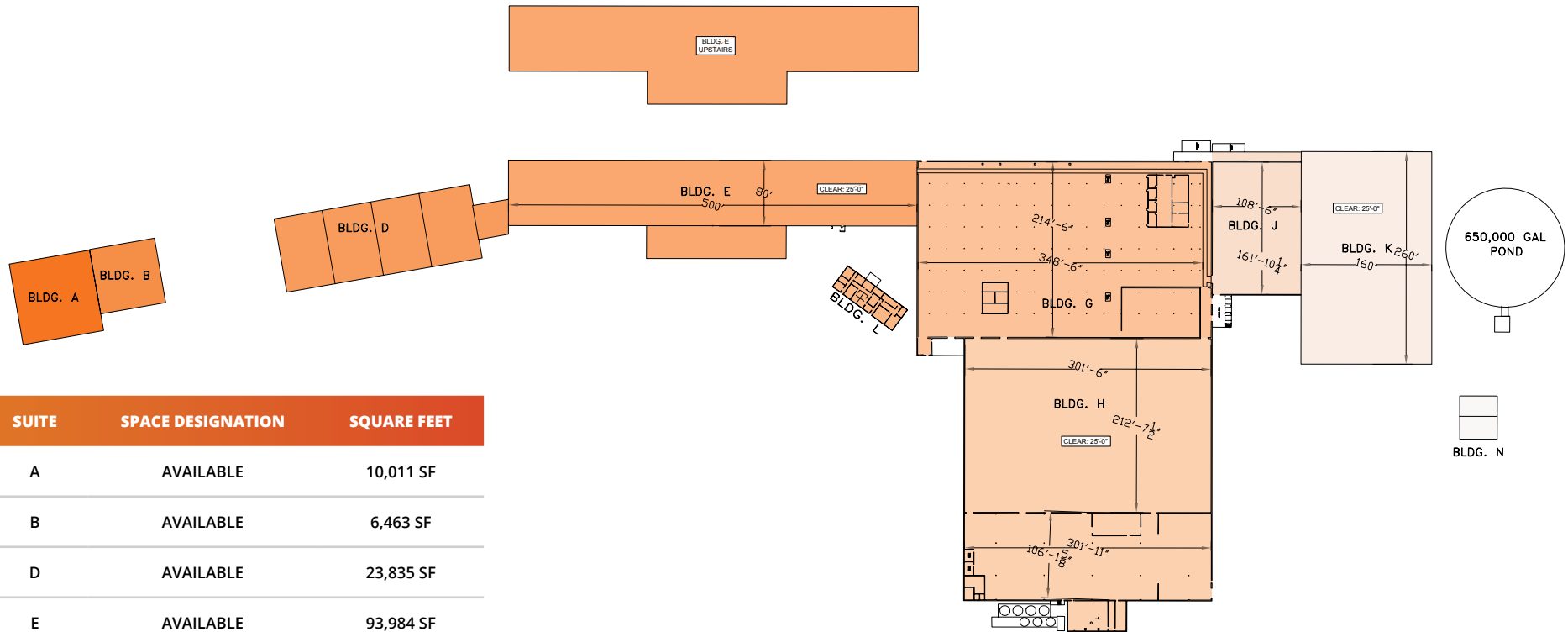

SUITE	SPACE DESIGNATION	SQUARE FEET
A	AVAILABLE	10,011 SF
B	AVAILABLE	6,463 SF
D	AVAILABLE	23,835 SF
E	AVAILABLE	93,984 SF
L	AVAILABLE	2,892 SF
G	AVAILABLE	78,658 SF
H	AVAILABLE	100,649 SF
J	AVAILABLE	17,936 SF
K	AVAILABLE	41,636 SF
N	AVAILABLE	2,428 SF
<b>TOTAL</b>		<b>378,492 SF</b>

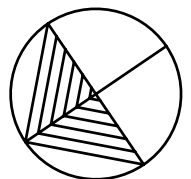

# LOCATION MAP

342 SHELBYVILLE MILLS RD | SHELBYVILLE, TN

US-41	3 MILES
I-24	21 MILES
HUNTSVILLE, AL	58 MILES
NASHVILLE, TN	61 MILES
CHATTANOOGA, TN	98 MILES

